

CERTIFIED SURVEY MAP

Located in
 THE NORTHWEST 1/4 OF THE SOUTHEAST 1/4,
 & THE SOUTHWEST 1/4 OF THE SOUTHEAST 1/4,
 OF SECTION 13, TOWNSHIP 9 NORTH, RANGE 18 EAST,
 TOWN OF ERIN, WASHINGTON COUNTY, WISCONSIN.

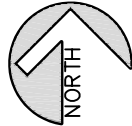

1" = 200'

CENTER OF SECTION 13-9-18
 (WASHINGTON COUNTY MON.)
 N 457,895.00
 E 2,450,032.03

EAST 1/4 CORNER SECTION 13-9-18
 (WASHINGTON COUNTY MON.)

N 457,998.58
 E 2,452,669.67

OUTLOT 1 MAY NOT BE SOLD SEPERATELY FROM LOT 1.
 ALL UTILITIES AND CABLE TV CONNECTIONS MUST BE INSTALLED UNDERGROUND.

BEARINGS ARE BASED ON THE WISCONSIN STATE PLANE COORDINATE SYSTEM (SOUTH ZONE), AND THE NORTH LINE OF THE SE 1/4 OF SECTION 13 T9N R18E (ASSUMED TO BEAR N 87°45'04" E)

- LEGEND**
- ⊙ -SET 1" IRON PIPE
 - -FOUND 1" IRON PIPE
 - ⊙ -SOIL BORING
 - (R) -RECORDED DISTANCE OR BEARING

DETAIL
 1" = 60'

Outlot 1
 39,840 SF ±
 (UNBUILDABLE)

JO ANN KIECKHAEFER

SE 1/4 SEC. 13-9-18
 LOCATION SKETCH

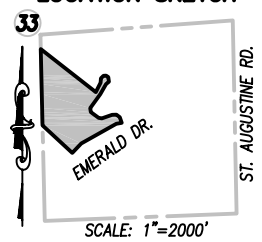

UNPLATTED LANDS OF OWNER

Lot 1
 311,390 SF ±

Outlot 2
 77,365 SF

Lot 2
 348,480 SF

JOSEPH E. & BARBARA KOHLER

CURVE TABLE					
CURVE	LENGTH	RADIUS	CHORD BEARING	CHORD DISTANCE	
C1	307.11	60.00	293°15'58"	N59°38'56"W	66.00
C2	42.41	27.00	90°00'00"	N08°59'42"W	38.18
C3	25.96	27.00	55°05'40"	N81°32'32"W	24.97
C4	146.36	93.00	90°10'13"	N64°00'16"W	131.72
C5	42.49	27.00	90°10'13"	S64°00'16"E	38.24
C6	89.43	93.00	55°05'40"	S81°32'32"E	86.02
C7	146.08	93.00	90°00'00"	S08°59'42"E	131.52
C8	73.04	93.00	45°00'00"	S31°29'42"E	71.18
C9	73.04	93.00	45°00'00"	S13°30'18"W	71.18

ROBERT F. MISIORA
 C.S.M. 1646

DB